

Room for Everyone

ALL GENDER WASHROOM
LAKEHEAD ORILLIA CAMPUS MAP



Lakehead
UNIVERSITY

Room for Everyone

In line with our Equity, Diversity and Inclusion Action Plan, Lakehead has expanded the number of all gender washrooms across campus. Some washrooms remain gender-specific but are inclusive for all those who identify with that gender. Signage will be placed near all gender washrooms indicating that these spaces are inclusive and that Lakehead respects everyone's right to choose the washroom that is appropriate for them.

Having access to a secure washroom is a basic right for all people and having all-gender washrooms available is an important part of making our campus safe, accessible, and welcoming for all of the Lakehead community. These washrooms are safe spaces where anyone, regardless of gender identity or presentation, can use the toilet, wash their hands and check the mirror. They decrease anxiety and fear for trans and gender diverse people while using the facilities as there is less chance of physical or verbal harassment or assault – a real and ongoing risk in gender-segregated spaces. In addition to providing a secure space for members of the trans and gender-diverse community, all-gender washrooms provide comfortable options for community members who require the assistance of a personal care attendant and/or those

with young children. With that said, all members of the Lakehead community are welcome to use these washrooms.

The bathrooms that will be designated all gender include:

Lakehead Orillia

- Academic Building - OA 1034
- Cafeteria Building - OC 1002D
- Orillia Residence Building - OR 1003

Lakehead Thunder Bay

- Advanced Technology & Academic Centre (ATAC) - 1011, 1012
- Bartley Residence - 115A
- Bora Laskin Faculty of Law Building (PACI) - 1002E, 014A, 1009
- C. J. Sanders Fieldhouse - 0024B, 0024A
- Centennial Building - CB 4011, 4023, 4059

- Centre for Advanced Studies in Engineering and Sciences (CASES) - FB 2022, 2021
- Chancellor Paterson Library (1st and 4th floor) - 1013, 1014, 4014, 4015
- Prettie Residence (Student Health & Wellness) - 103A
- University Centre - UC 2029



NOTE: This is an example of a sign

Academic Building

FIRST FLOOR

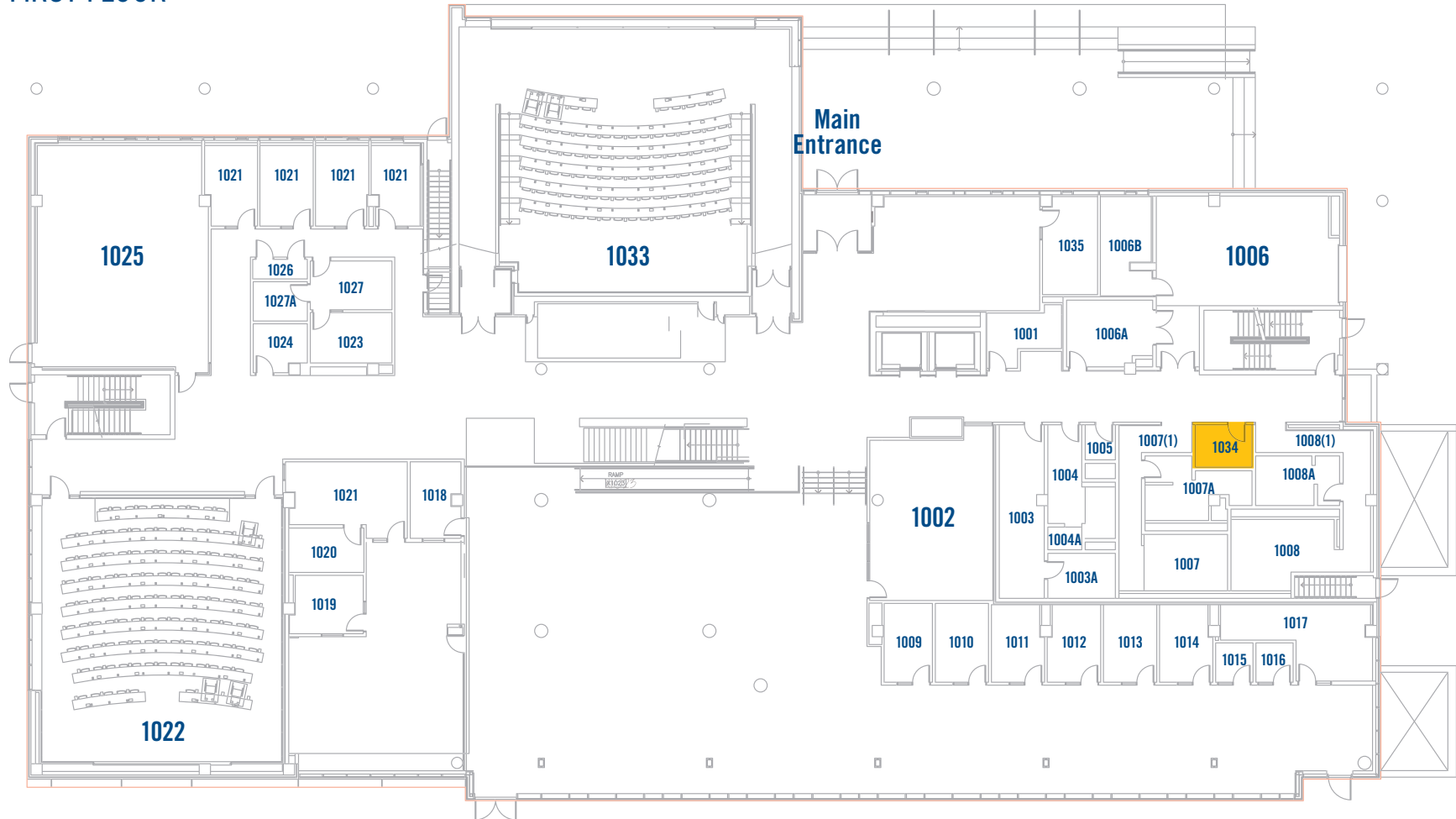

All-Gender Washroom
depicted in yellow

Room: OA 1034

NOTE: This is an example of a sign

Cafeteria Building

FIRST FLOOR

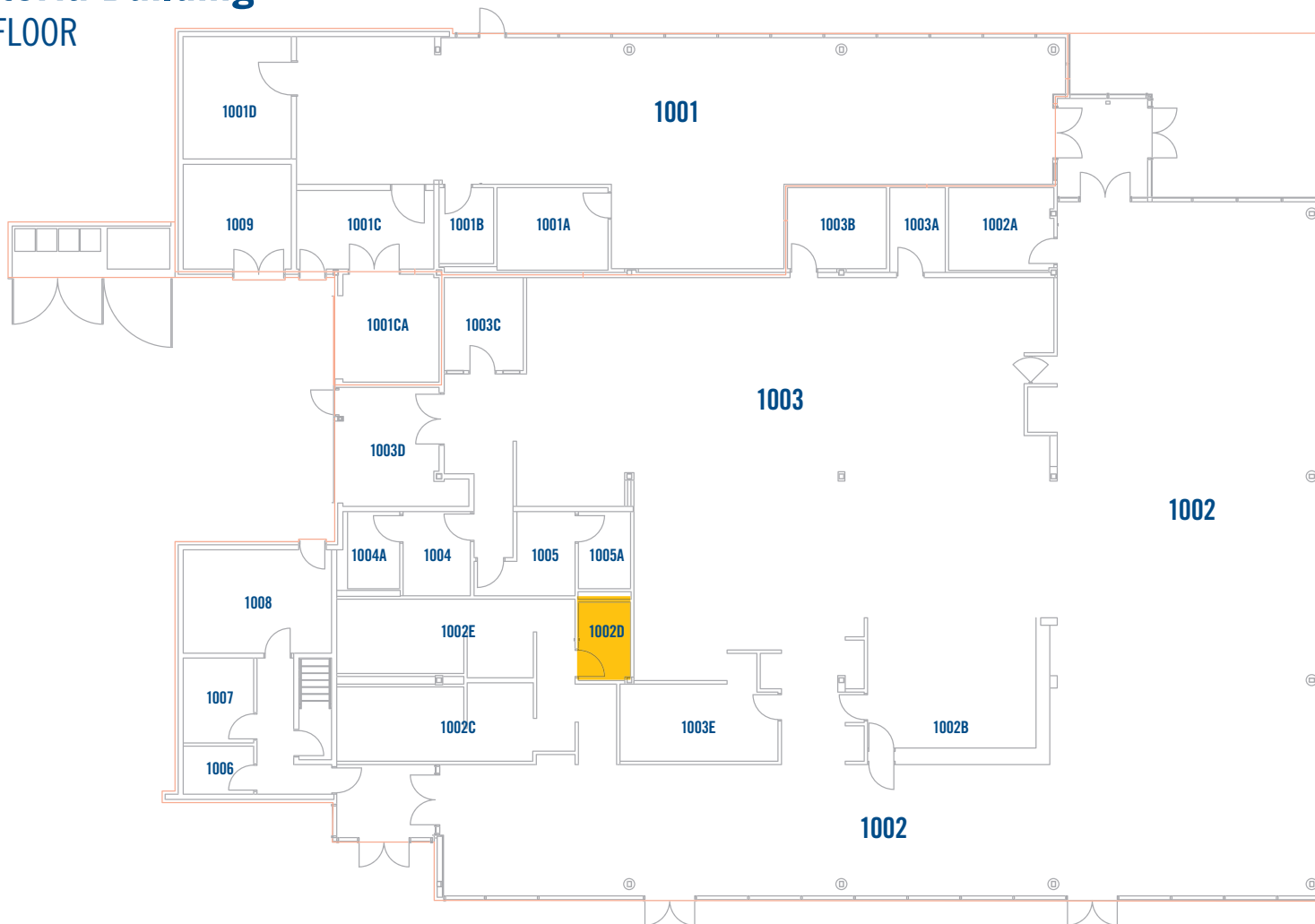

**All-Gender Washroom
depicted in yellow**

Room: OC 1002D

NOTE: This is an example of a sign

Residence Building

FIRST FLOOR



**All-Gender Washroom
depicted in yellow**

Room: OR 1003

NOTE: This is an example of a sign